

NORTH POINT

CABINETS®





The NorthPoint Cabinetry Solution

NorthPoint Cabinetry features a wide array of **QuickBuild**® cabinet designs, providing value with a quality, custom look. Cabinets are in stock, shipping quickly from our strategically located warehouses across the U.S.

- Unique dovetail and pocket screw cabinet construction for sturdy and fast assembly
- Robust replacement parts program
- Free freight on most orders
- Dedicated customer service support



For more information, visit NorthPointCabinetry.com or scan the QR code.

With 6 dedicated warehouses across the country, NorthPoint Cabinetry typically ships within 48 hours and arrives in 2–3 business days.

The Quick Advantage

Ships QUICKLY, Assembles FAST

NorthPoint Cabinetry offers a **quick** advantage for you and your customer by making it fast and easy to design, order, ship & assemble cabinets. **Why does this matter?** With a reduction in time and labor, you can complete more jobs and see significant savings.

Some specific ways the NorthPoint Cabinetry Quick Advantage can save you time & money:

- **Quick to Design**

Our cabinets are available in 2020 and ProKitchen software, making kitchen design fast and easy.

2020



- **Quick to Order**

Place an order for your cabinets with our quoting tool, on our website at NorthPointCabinetry.com, or by contacting a live customer service agent.

- **Quick to Ship**

With 6 dedicated warehouses across the country, orders typically ship within 48 hours and arrive in 2–3 business days.



- **Quick to Assemble**

With our **QuickBuild**® cabinets, the average assembly time per cabinet is 8 minutes*; you can build a medium-sized kitchen in less than half a day.

Quality Comes First

You can trust NorthPoint Cabinetry for your customers. Our cabinets and hardware have gone through rigorous third-party testing and meet the KCMA standards. With quality details throughout and the features your customer will appreciate, NorthPoint Cabinetry is built to last.



It Starts with Quality Wood

Just as a healthy tree needs strong roots to thrive, a quality cabinet requires premium lumber at its core. The quality of wood is of utmost importance, so our cabinets feature all-wood construction.

Structural Integrity

Meaningful yet hidden reinforcements—like solid wood corner blocks and strategically placed pocket screws—help reinforce the structural integrity of the cabinet. Take comfort that these well-constructed cabinets will stand the test of time.



Thoughtful Craftsmanship

These cleverly designed cabinets boast an innovative dovetail and hidden pocket screw construction that provides robust quality and quick, accurate assembly.

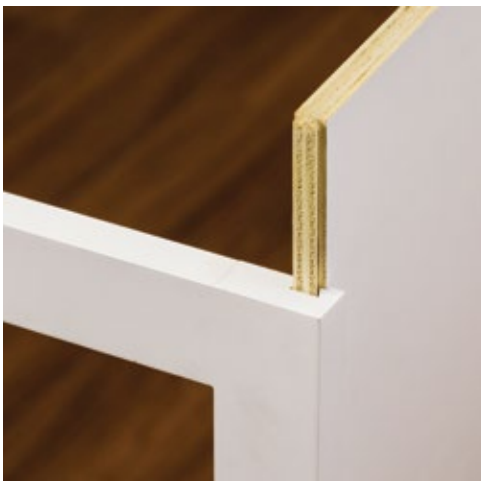



Pretty on the Inside, Too

NorthPoint Cabinetry features a clean and beautifully finished birch interior that enhances the cabinet's luxurious, high-quality appeal.

Premium Drawer Boxes

Dovetail joinery is the hallmark of high-quality drawer boxes. The UV finish of the drawer boxes coupled with the dovetail construction, and smooth concealed slides are synonymous with quality furniture.



Hardworking Hardware

Our cabinets feature discreet compact hinges and concealed undermount slides. The hinges and slides have been third-party tested and exceed industry standards. The Premier Collection (shown) features full extension slides, allowing for easy access and use of the whole drawer.

Sturdy Shelves

NorthPoint Cabinetry shelves are constructed from an impressive $\frac{3}{4}$ " thick veneered plywood, preventing sagging over time under the weight of normal use. Shelf height is adjustable, so the homeowner can optimize storage space.



Expert Finishing

Count on consistent, high-quality finishing. Our state-of-the-art manufacturing facility utilizes a multi-step professional finishing process. This meticulous process maintains a high degree of color and application accuracy from cabinet to cabinet, ensuring a beautiful run of cabinets when installed.



ESPRESSO



SLATE



NEW SANDSTONE



PEBBLE GREY



POLAR WHITE

What are **QuickBuild**[®] Cabinets?



Dovetail + Pocket Screws = QuickBuild[®]

Basic assembly of our cabinets is as simple as sliding the panels together and securing with pocket screws. You don't need extra fasteners to hold the panels in place, and conveniently placed pocket screws will reduce the average time you spend on each cabinet.



How fast can you build a cabinet?

One of our cabinets takes about 8 minutes* to assemble (many do it in 4). You can build a kitchen or bathroom in record time!



Scan the QR code or go to <https://delivr.com/2kcvh> to view our Quick Assembly Video.

Our Collections



PREMIER Collection

The Premier Collection features elegant upgrades like soft-close doors and drawers.

Door Styles: Catalina, Maui

- 3/4" solid wood face frame & shelves
- 1/2" plywood cabinet construction
- Beautiful, finished interior
- 5-Year limited lifetime warranty





ESSENTIALS

Collection

The Essentials Collection delivers on style at an impressive value.

Door Style: Hatteras

- 3/4" solid wood face frame & shelves
- 1/2" plywood cabinet construction
- Beautiful, finished interior
- 1-Year limited lifetime warranty

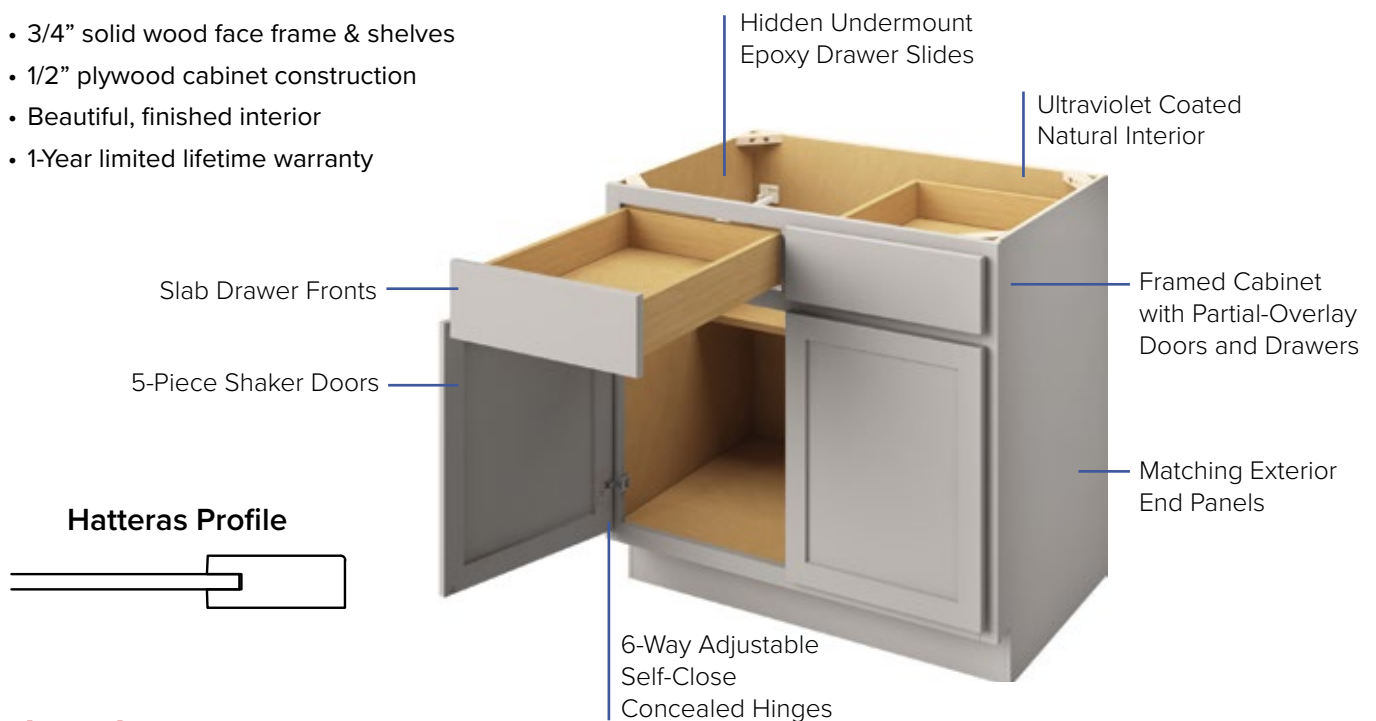

PREMIER COLLECTION: CATALINA





CATALINA FINISHES

More than modern. The Catalina door style features a full-overlay, Shaker-style door and 5-piece drawer front.

POLAR WHITE



PEBBLE GREY



ESPRESSO

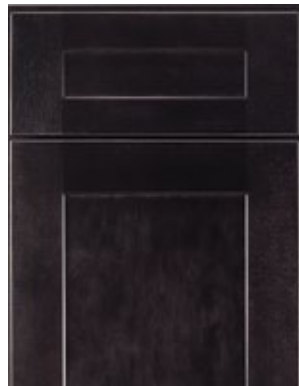

SLATE



NEW SANDSTONE



PREMIER COLLECTION: MAUI





MAUI FINISHES

Sometimes the details make all the difference. The Maui door style features a full-overlay, transitional-style door and 5-piece drawer front with a twist of character.



POLAR WHITE



PEBBLE GREY



ESPRESSO*



SLATE



**Call for availability*

ESSENTIALS COLLECTION: HATTERAS





HATTERAS FINISHES

Simple and sleek. The Hatteras door style features a partial-overlay, Shaker-style door and slab drawer front.



POLAR WHITE



PEBBLE GREY



ESPRESSO



NEW SLATE



Cabinets for Any Space

The kitchen and bath are common spaces to install cabinetry. However, NorthPoint Cabinetry provides solutions for other spaces like the laundry room, mudroom, and entertainment areas. Cabinets make those areas more functional by providing additional storage and countertop work space.



Wine Bar

Catalina Pebble Grey Cabinets

Decorative Cabinet Hardware: Marlo in Satin Nickel



Mudroom

Maui Polar White Cabinets
Decorative Cabinet Hardware:
Ella Collection in Brushed Oil
Rubbed Bronze
Decorative Hooks:
Emerald in Brushed Oil
Rubbed Bronze



Laundry Room

Catalina Slate Cabinets
Decorative Cabinet Hardware:
Hudson Collection
in Satin Nickel

Versatile Vanity Cabinets

Our kitchen and vanity cabinets are made with the same dependable quality and construction. The vanity door styles and finishes match our kitchen cabinet collections, which allows you to design coordinated spaces for your clients and create an intelligent design flow from kitchen to bathroom. Mix up the design styles and finishes from room to room if that best fits the design personality

We offer many different vanity cabinet configurations that allow our cabinets to perfectly fit most bathroom spaces. Options like linen cabinets and all drawer cabinets go the extra mile to make the bathroom space functional and beautiful.



Catalina Polar White Cabinets
Decorative Cabinet Hardware: Tahoe Collection in Black

Create Your Customer's Perfect Vanity

Our cabinets are designed to mix and match for a customized solution to fit your customer's lifestyle. Need more drawers? No problem. Prefer one sink and lots of counter space? We've got you covered. Here are some popular combinations to get you started designing the perfect vanity for your customer.

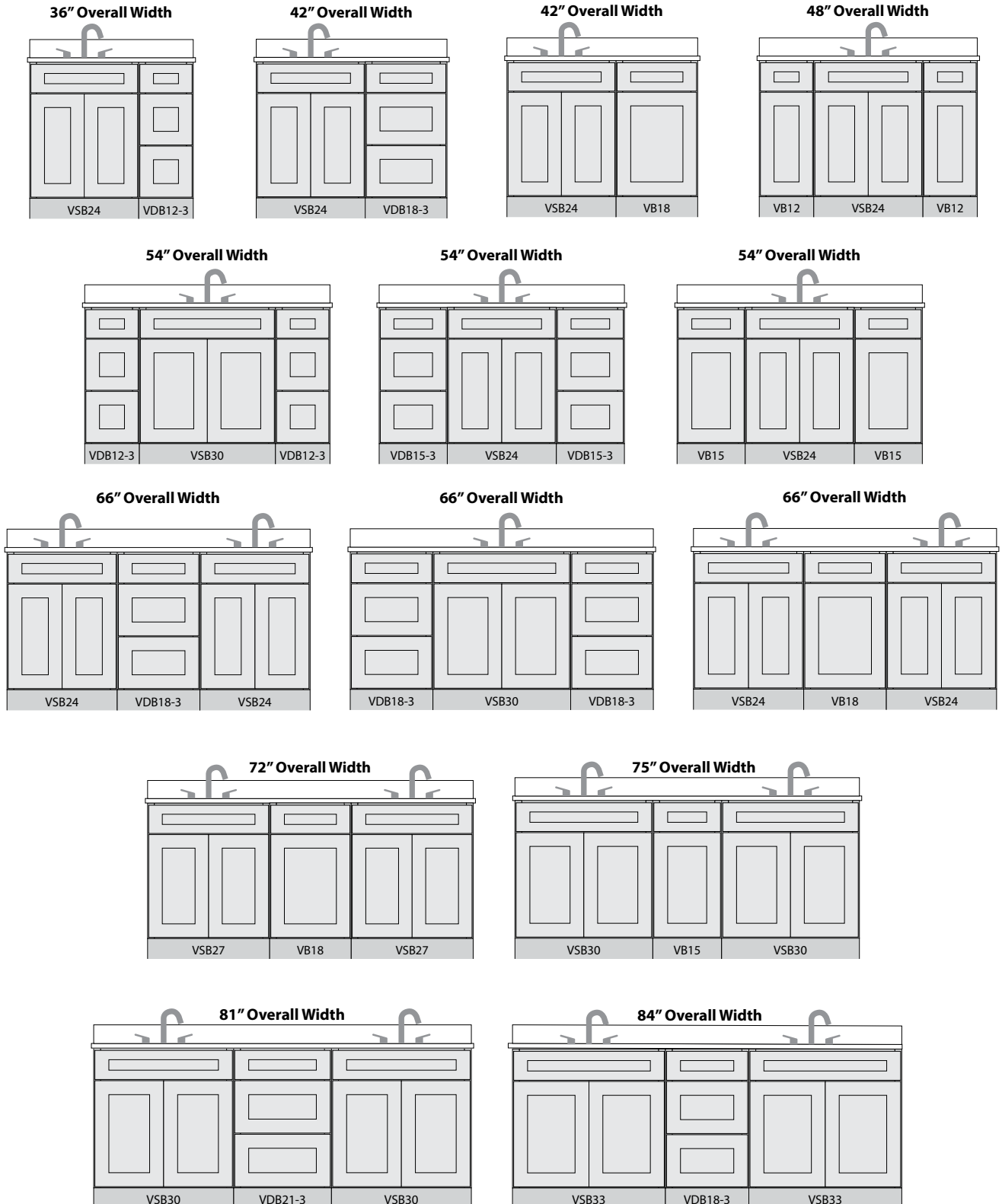

Catalina Polar White Cabinets
Decorative Cabinet Hardware:
Cordova in Satin Nickel
VBTD42





Maui Espresso Cabinets
 Decorative Cabinet Hardware: Bremen 2 in Gun Metal
 VSB30, VDB15-3 & VL1884



Maui Pebble Grey Cabinets
 Decorative Cabinet Hardware: Florence in Satin Bronze
 VSB24 & VDB12-3



Maui Polar White Cabinets
 Decorative Cabinet Hardware: Hayworth in Matte Black
 VSB24

Cabinet Lineup

WALL CABINETS

12" deep except where noted
 42" high wall cabinets will have 3 shelves
 *39" and 42" widths will have a vertical center stile unless otherwise noted

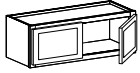

Double Door
 12" Height
 30", 33", 36",
 or *39" Width

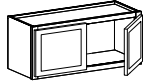

Double Door
 15" Height
 30", 33", 36",
 or *39" Width

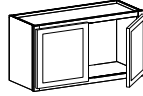

Double Door
 18" Height
 21", 24", 30", 33", 36",
 or *39" Width

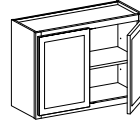

Double Door
 24" Height
 30", 33", 36", or *39" Width

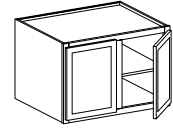

Deep Double Door
 18" or 24" Height • 24" Depth
 36" or *39" Width
 18" Height does not have shelf

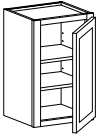

Single Door
 30" Height
 9", 12", 15", 18", or 21" Width

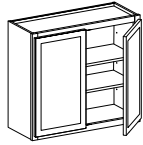

Double Door
 30" Height
 24", 27", 30", 33",
 36", *39", or *42" Width

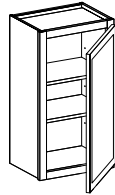

Single Door
 36" Height
 9", 12", 15", 18", or 21" Width

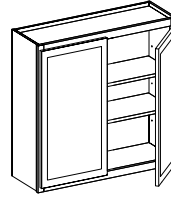

Double Door
 36" Height
 24", 27", 30", 33",
 36", *39", or *42" Width

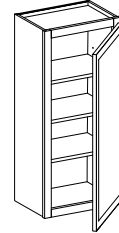

Single Door
 42" Height
 9", 12", 15", 18", or 21" Width

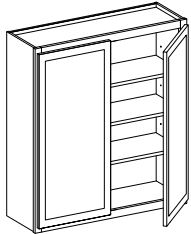

Double Door
 42" Height
 24", 27", 30", 33",
 36", *39", or *42" Width

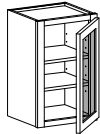

Single & Double Glass Door
 Matching Finish Color Interior
 30" Height
 15", 18", 30", or 36" Width

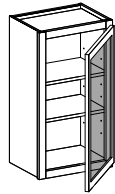

Single & Double Glass Door
 Matching Finish Color Interior
 36" Height
 15", 18", 30", or 36" Width

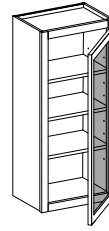

Single & Double Glass Door
 Matching Finish Color Interior
 42" Height
 15", 18", 30", or 36" Width

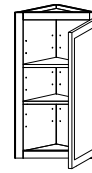

Wall End Single Door
 30", 36", or 42" Height
 12" Width

Glass door wall cabinets only available in the Premier Collection

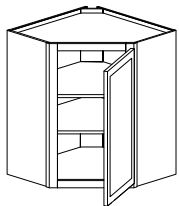

Diagonal Corner
 30", 36", or 42" Height
 12 or 15" Depth
 24" or 27" Width

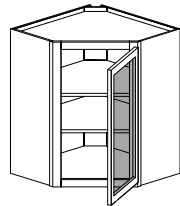

Diagonal Corner Glass Door
 Matching Finish Color Interior
 30", 36" or 42" Height
 12 or 15" Depth
 24" or 27" Width

Glass door wall cabinets only available in the Premier Collection

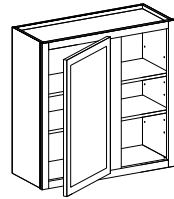

Universal Blind Corner
 30", 36", or 42" Height
 30"-33" Width

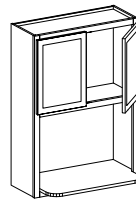

Microwave Wall Cabinet
 Extended Shelf
 36" Height
 30" Width

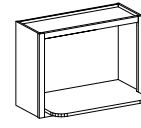

Microwave Wall Cabinet
 Extended Shelf
 18" Height
 30" Width

BASE CABINETS

24" deep, 34-1/2" high
 except where noted

*39" and 42" widths will
 have a vertical center stile
 unless otherwise noted

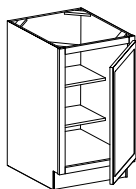

**Full Height
 Single Door**
 9", 12", 15", or 18" Width

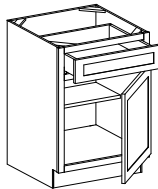

**Single Door
 and Drawer**
 12", 15", 18", or 21" Width

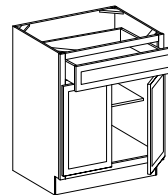

**Double Door and
 Single Drawer**
 24", 27", or 30" Width

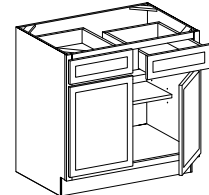

**Double Door and
 Double Drawer**
 33", 36", *39", or *42" Width

Thousands of Cabinet Options in Stock for Quick Delivery

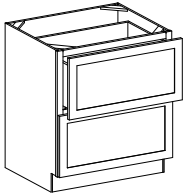

Double Drawer
30" or 36" Width

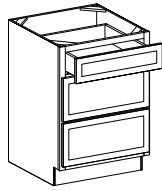

Triple Drawer
12", 15", 18", 21", 24", 30",
or 36" Width

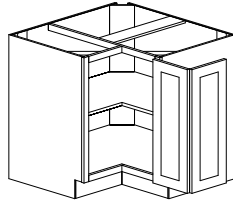

Base Corner Cabinet
33" or 36" Width
(Lazy Susan inserts available)

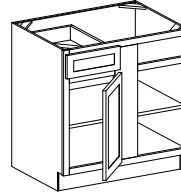

**Universal Blind
Base Corner**
39"-42", 42"-45", or
45"-48" Width

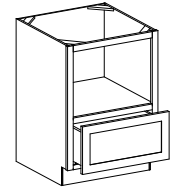

**Microwave Base
Cabinet with Drawer**
30" Width

SINK BASE CABINETS

24" deep, 34-1/2" high
except where noted.

*39" and 42" widths will
have a vertical center stile
unless otherwise noted

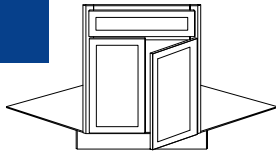

**Corner Sink Front
Double Door**
24" Depth
(2-piece bottom panel)

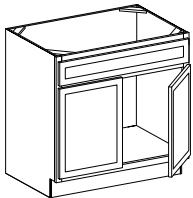

**Sink Base
Double Door**
30", 33", 36", or 39" Width

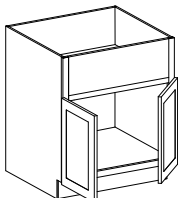

**Farmhouse Sink
Base Double Door**
36" or 39" Width
(No center stile)

TALL CABINETS

24" deep except
where noted.

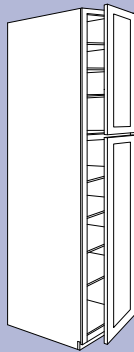

**Utility/Pantry
Single Door**
84", 90" (6 shelves),
or 96" Height (7 shelves)
18" Width

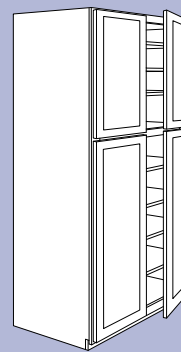

**Utility/Pantry
Double Door**
84", 90" (6 shelves),
or 96" Height (7 shelves)
24" or 30" Width

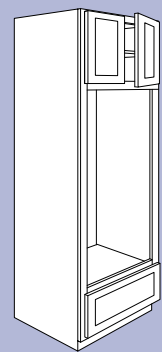

**Oven Double Door,
Single Drawer**
84", 90", or 96" Height
33" Width
*Single shelf in 96" only
(Double Oven Overlay Panel available)

VANITY CABINETS

21" deep, 34-1/2" high
except where noted

*42" widths will have a
vertical center stile

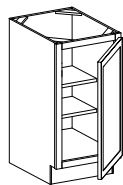

Single Door
12" Width

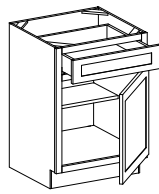

**Single Door
and Drawer**
12", 15", or 18" Width

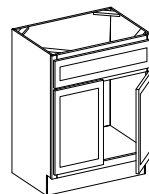

Double Door
24", 27", 30", 33",
or 36" Width

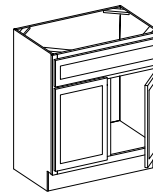

**Double Door
Center Stile**
42" Width

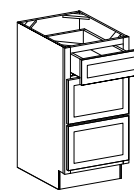

Triple Drawer
12", 15", 18", or
21" Width

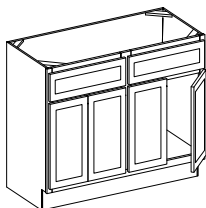

Two Double Door
48" Width

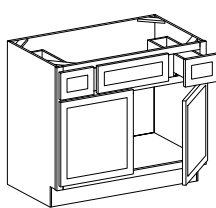

**Double Door and
Double Drawer**
36", 42", or 48" Width

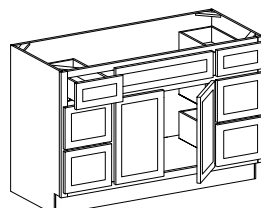

**Double Door and
Six Drawer**
60" Width

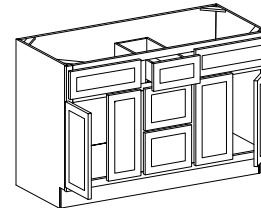

**Two Double Door and
Triple Drawer**
60" Width

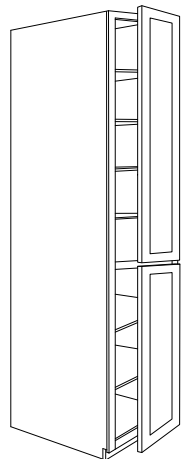

**Linen Single &
Double Door**
84" (6 shelves)
Single: 15" and 18" Width
Double: 24" Width

Complete the Look with Accessories

Add the finishing touch to your customer's cabinets with our broad selection of cabinet accessories. Whether your client's ideal space is traditional, transitional, or contemporary, we have the selection available to transform the space from ordinary to extraordinary.



MOULDING

Crown, toe kick, light rail, scribe, and accent moulding options available

Available in all finishes:

Polar White, Pebble Grey,
Espresso, Slate, and Sandstone

OVERLAY FILLERS

Fluted and smooth options available

Available in all finishes:

Polar White, Pebble Grey,
Espresso, Slate, and Sandstone





DECORATIVE PANELS

Available in all finishes:
Polar White, Pebble Grey,
Espresso, Slate, and Sandstone

DECORATIVE WOOD

Available in all finishes & door styles:
Polar White, Pebble Grey,
Espresso, Slate, and Sandstone



SPECIALTY CABINETS

Available in all finishes:
Polar White, Pebble Grey,
Espresso, Slate, and Sandstone



Knobs & Pulls

JEFFREY ALEXANDER[®]
by Hardware Resources

E L E M E N T S[®]
by Hardware Resources

Cabinets from NorthPoint Cabinetry are not complete without Jeffrey Alexander or Elements cabinet knobs and pulls! Your clients can personalize their space—really bringing their style to life. Cabinet knobs and pulls often take center stage by adding the finishing touch on the perfect design. There are **1,000s of different knobs and pulls for your clients to choose from** in various sizes, finish options, and price points so that they can achieve that perfect look.

See our full offering of cabinet knobs & pulls on pages 7–212.



Satin Nickel Pulls

Leyton from Jeffrey Alexander
Maui Espresso Cabinets



Matte Black Pulls

Wheeler from Jeffrey Alexander
Catalina Polar White Cabinets



Satin Bronze Pulls

Thatcher from Elements
Catalina Espresso Cabinets



Brushed Gold Pulls

Naples from Elements
Hatteras Polar White Cabinets

Create an Organized & Efficient Kitchen

Cabinet design is not only about aesthetics—functionality of the space is an important factor. Improve your client's experience with Organizers that conquer clutter and make reaching items easy and efficient. See our full offering of Organizer products on pages 301–492.

Neatly Tuck Away Trash Cans

Pick a trash can solution that best fits your kitchen and your budget.

- Wood Bottom Mount Trash Can
- Economy Soft-Close Trash Can
- Storage with Style® Trash Can Pullout



✓ POPULAR



Organization Within Reach

Maximize cabinet storage with base cabinet organizers. Choose pullout organizers to maximize storage and eliminate the reach.

- "No Wiggle" Base Pullout
- Mixer Lift
- Storage with Style® Base Pullout



For more information on cabinet organizers, scan the QR code or visit delivr.com/272ju

See the NorthPoint Cabinetry Cross Reference Guide in the NorthPoint Cabinetry Spec Book to determine which organizers fit in each cabinet.



Corner Storage That Comes To You

Bring the deep recesses of corner cabinets forward with corner organizers.

- Easy 360 Susan
- Half-moon Lazy Susan
- Storage with Style® Blind Corner Pullout

Tame Drawer Clutter

Drawer inserts help organize everything from cutlery to spices to dishes.

- Cutlery Drawer Insert
- Spice Rack Drawer Insert
- Coffee Pod Drawer Insert

✓ POPULAR



Organize Heavily Used Cabinets

Go from disorder to order with solutions for challenging storage areas.

- Easy Access Pantry Pullout
- Double Drawer Bottle Rollout
- Storage with Style® Pullout Baskets

Add Lighting to Brighten the Kitchen



Highlight the beauty of your cabinet design with LED lighting from Task Lighting & Power. Select from a variety of assembled linear fixtures, tape lighting, puck lights, and specialty lighting—allowing your clients to set the mood in any room.

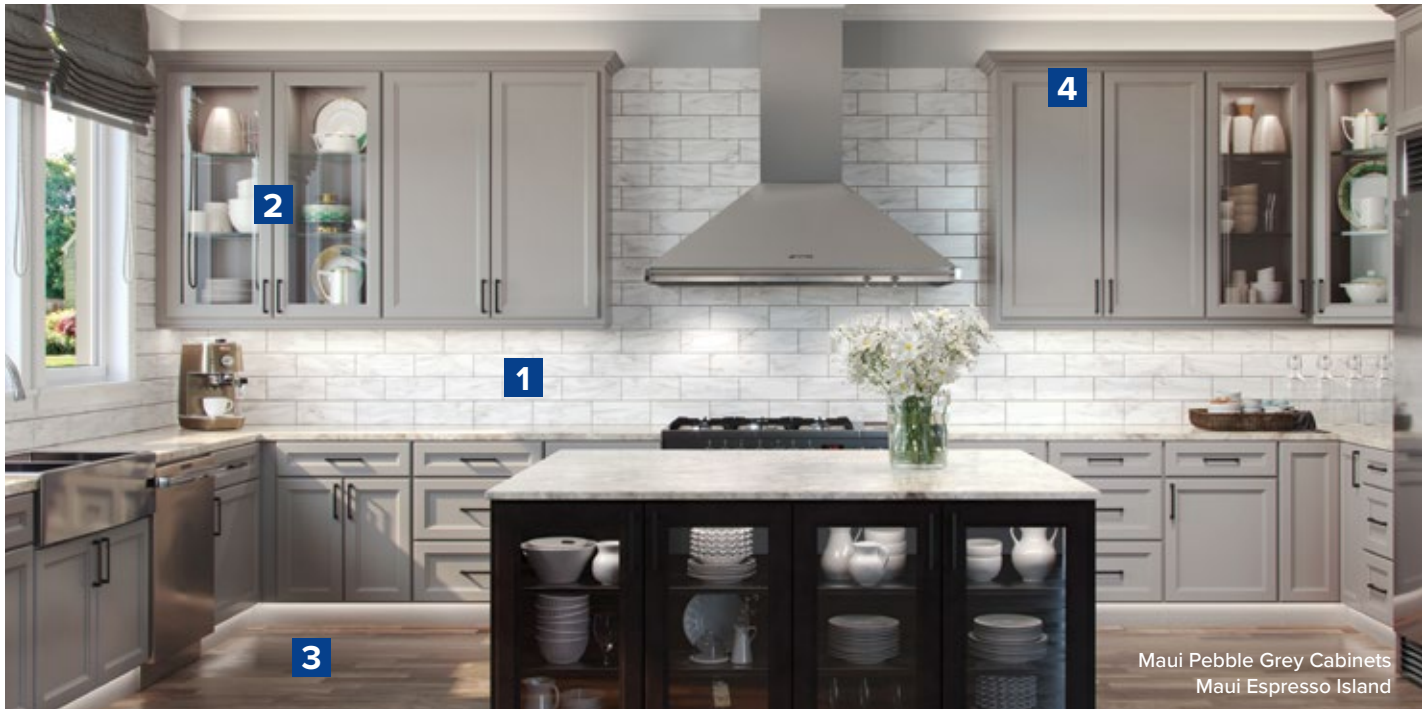

1 *Illuminate countertops with Under Cabinet Lighting*

Illuminate countertops with under cabinet lighting to enhance functional spaces, highlight beautiful backsplashes, or eliminate shadows created from cabinets. Under cabinet lighting creates ample illumination for meal prep and reading recipes.

2 *Accentuate decorative items on display with In Cabinet Lighting*

Use lighting in glass-faced cabinets to accentuate decorative items on display or highlight beautiful crystal and china. Adding lighting inside a glass door cabinet gives a nice wash of light throughout the cabinet.

3 *Highlight beautiful flooring with Toe Kick Lighting*

Add lighting under the toe kick to highlight beautiful flooring during the daytime. At night, keep floors safely illuminated with a gentle glow for midnight snacking.

4 *Add ambiance and make the space feel larger with Above Cabinet Lighting*

Add depth and ambiance to your kitchen by highlighting the open space above cabinets to increase the aesthetic appeal and make the space feel larger.





Linear Fixtures available in 14 lengths to fit under cabinets 9”–48”



Angled Linear Fixture

Install under or in a cabinet to angle the light where it's needed.



Flat Linear Fixture

Install under a cabinet to illuminate the workspace below.



Recessed Linear Fixture

Recess into a frameless cabinet or shelf for a flush, sleek finish.

- No assembly required—fixtures snap into single-screw mounting clips for secure installation
- Designed to fit standard cabinet widths for simplified ordering
- Select between 3000K or 4000K for single-white or select tunable-white lighting for 2700K–5000K and all Kelvin temperatures in between

For more information on Linear Fixtures, see the Task Lighting & Power section on pages 493–600.

- Easy two-wire connection at either set of terminals
- Dimmable with wireless, wired, or Smart Home enabled control
- The economical choice—great price, fast installation, uses regular wire, not jumpers

ASSEMBLED
IN THE
USA

Don't know where to start?

Get connected with one of our friendly in-house Design Services team members to help you pick out the lighting products that will work best in the space.

866.848.9094

DesignAndSupport@TaskLighting.com

Hide Unsightly Power Outlets



Angle Power Strip fixtures tuck away hidden power right where it's needed and are the perfect alternative to standard outlets that disrupt the beauty of glass, tile, or solid-surface backsplashes.



18" Black fixture* with USB charging outlets



18" Satin Nickel fixture* with USB charging outlets



18" Bronze fixture* with USB charging outlets



18" White fixture* with USB charging outlets

ASSEMBLED
IN THE USA



5 YEAR
WARRANTY



For more information on Angle Power Strip fixtures, scan the QR code or visit www.TASKLighting.com

*Available in standard lengths from 9" to 72", custom options available



Tucked away electrical power, plus switches to control lighting, garbage disposal

Lighted Power Strip
Combines LED lighting and angled power outlets

ASSEMBLED
IN THE USA

Hatteras Polar White Cabinets, Hatteras Pebble Grey Island
Decorative Cabinet Hardware: Naples Collection in Brushed Gold



Angle Power Strip tucked up under the cabinet preserving the backsplash (and "disappears" when standing)

ELIMINATE THOSE UNSIGHTLY POWER OUTLETS WITH SLEEK, HIDDEN ANGLE POWER STRIP FIXTURES



Light & Power come together, out of sight beneath cabinets, with Lighted Power Strip fixtures. Now available with tunable-white lighting!

Lighted Power Strip tuned to Warm White 2700K

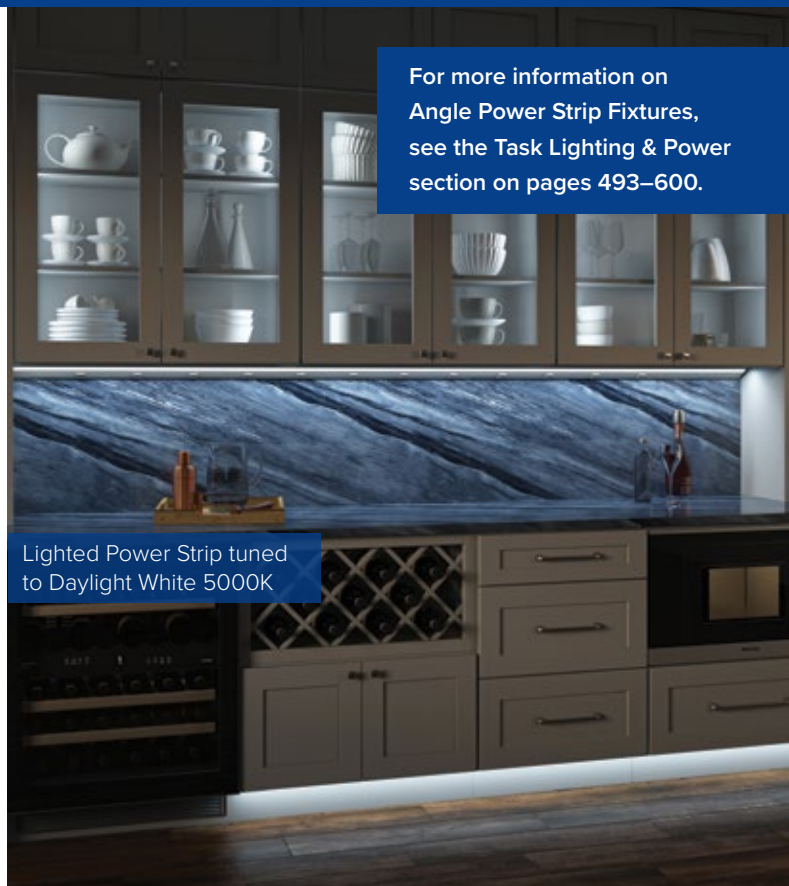

For more information on Angle Power Strip Fixtures, see the Task Lighting & Power section on pages 493–600.

Lighted Power Strip tuned to Daylight White 5000K

Resources

Assembly Videos



Base Cabinets
delivr.com/2s43x



Base Corner Cabinets
delivr.com/2r23p



Utility/Pantry Cabinets
delivr.com/29fgn



Double Oven Cabinets
delivr.com/28pgy

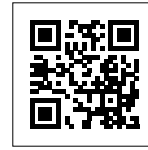

Wall Cabinets
delivr.com/25hbr



Wall Corner Cabinets
delivr.com/2d3s3



Wall End Cabinets
delivr.com/2krhy



Vanity Trim Kits
delivr.com/23n8d



Cabinet Rollout Tray
delivr.com/2fzzv

NorthPoint Cabinetry Videos



NorthPoint Brand Overview
delivr.com/2nyhg



Anatomy of a Cabinet
delivr.com/2zmba



Quick Advantage
delivr.com/2tuhn



Quick Assembly
delivr.com/2kcwh

Literature & Samples

Available on the Resources section of our website.



Homeowner Catalog



Homeowner Selection Guide



Spec Book



Price Book

Also available:
Touch Up Kits (not shown)



Mini Base Cabinets
12" W x 21" H x 15" D



Sample Door Kit



Moulding Sample Kit



Finish Sample Kit

Freestanding Selection Center

Make selection easy with a curated line of quality cabinets. Personalize cabinet designs with a wide offering of decorative & organization products.

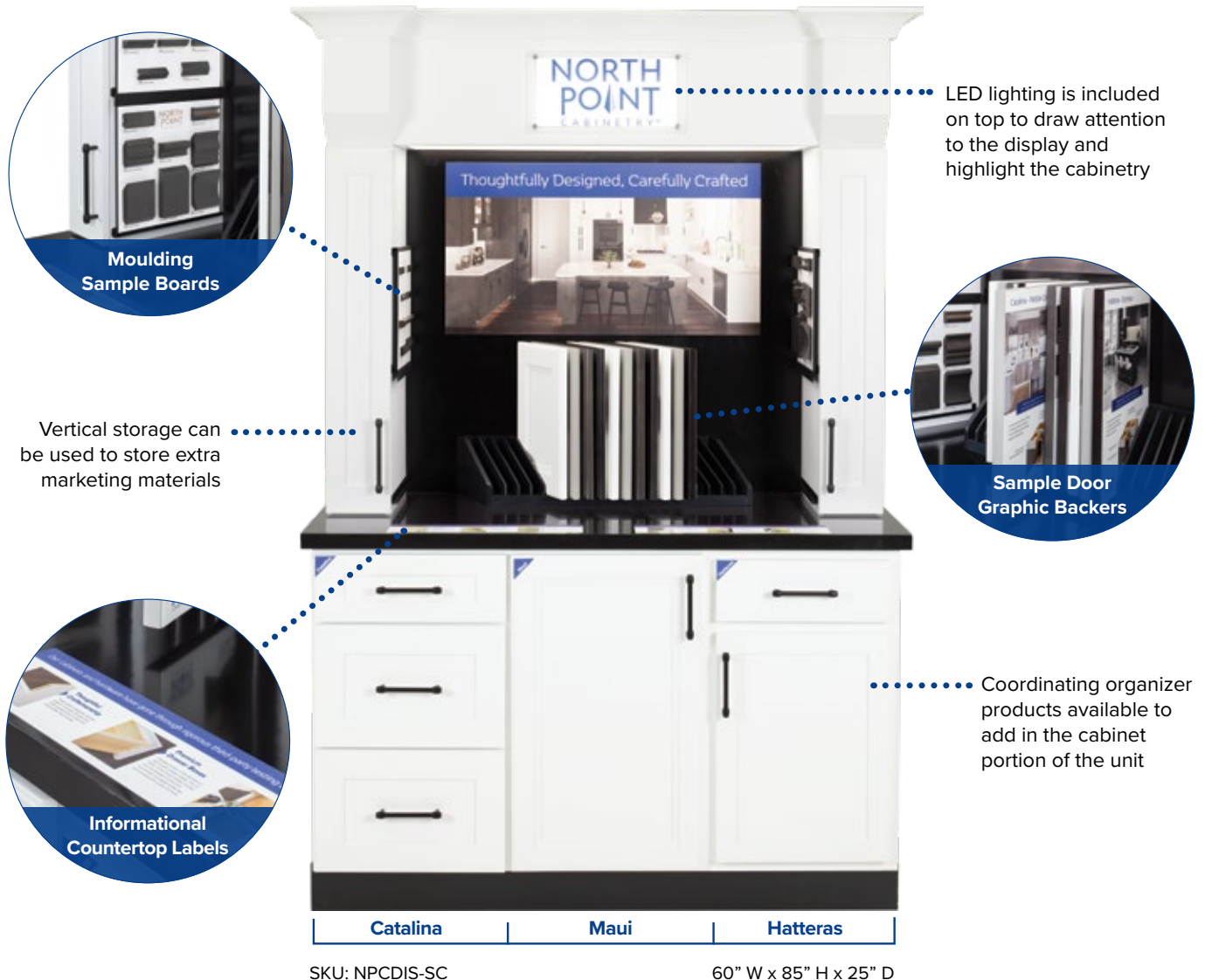

- One cabinet in each door style
- Door samples with informational backers
- Moulding sample boards
- Marketing materials included—catalog, spec book, and homeowner brochure
- Trending matte black finish hardware from the Hayworth Collection by Jeffrey Alexander
- Optional add-ons for decorative hardware and organizers
- Some assembly required

Ask your local sales representative about our display program and how to order a selection center for your showroom.

Ordering Made Easy

NorthPoint Cabinetry offers 3 convenient methods for easy order placement. We recommend placing orders online for faster processing and delivery and to easily confirm products are in stock.

1. Online: www.NorthPointCabinetry.com
2. Email: Orders@NorthPointCabinetry.com
3. Fax: (318) 742-9513

Order Placement

Place your online order by visiting www.NorthPointCabinetry.com. Login, select the items you wish to order, and simply checkout.

To order by email or fax, obtain a cabinet order form by logging in to the website, or request a form from a Customer Service team member or your sales representative. Submit the completed order form to the email address or fax number listed above. 2020 and ProKitchen material lists are also accepted as long as NorthPoint Cabinetry's item number nomenclature is used.

For questions about your order, call (800) 463-0660. Our friendly customer service agents are available to help you from 7am until 6pm Central Time.

Order Processing

Orders will be ready for pickup two hours after you have received your order confirmation email. Will Call orders are available for pickup at our facilities between the hours of 8am and 4pm local warehouse time. Should you have any questions about picking up your order or need to have the order modified in any way, contact your customer service representative. All requests for returns must be made within 60 days of invoice date. Returns are subject to a 20% restocking fee unless the return is due to Hardware Resources' error or a quality issue.

Returns

To request a Return Goods Authorization (RGA) contact Customer Service.

1. Phone: (800) 463-0660
2. Fax: (318) 742-9513
3. Email: ReturnRequest@HardwareResources.com

Include the item number, quantity and reason for return when requesting an RGA. Items should be in original packaging, unassembled, and shipped with care to avoid damage. Items received with damage may not be credited.

In the event that the return is due to an error by Hardware Resources, a return shipping label will be provided. Otherwise, shipments are the Customer's responsibility (including shipping fees) and should be shipped via a method which allows shipment tracking and proof of delivery.

Warranty

Premier Collection

Hardware Resources warrants to the original consumer purchaser that our Premier Cabinetry will be free from unnatural defects in material and workmanship under normal use and proper care for the period of FIVE (5) YEARS from the date of original purchase. This Limited Warranty applies only to the Original Purchaser and is not transferable to any other party.

WARRANTY COVERAGE

Limited 5-Year Warranty on Cabinets to the original purchasing consumer from the date of original purchase that the cabinets will be free from defects in material and workmanship under normal use and proper care. Limited Lifetime Warranty on Drawer Slides and Hinges to the original purchasing consumer as long as they own the product. We warrant that the drawer slides and hinges shall be free from defects in material and workmanship under normal use.

Essentials Collection

Hardware Resources warrants to the original consumer purchaser that our Essentials Cabinetry will be free from unnatural defects in material and workmanship under normal use and proper care for the period of ONE (1) YEAR from the date of original purchase. This Limited Warranty applies only to the Original Purchaser and is not transferable to any other party.

WARRANTY COVERAGE

Limited 1-Year Warranty on Cabinets and on Drawer Slides to the original purchasing consumer from the date of original purchase that the cabinets will be free from defects in material and workmanship under normal use and proper care. Limited Lifetime Warranty on Hinges to the original purchasing consumer as long as they own the product. We warrant that the drawer slides and hinges shall be free from defects in material and workmanship under normal use.